



Xitanium Constant Current Xtreme

Xitanium 75W 0.7A AOCCM 1-10V GL-Y sXt

Xitanium Xtreme LED drivers provide constant current output, optimal for a single string of LEDs. With exceptional operating efficiency, our drivers significantly reduce energy costs. The Xitanium Xtreme portfolio offers both central and standalone dimming protocols further increasing the energy savings and CO2 reductions achieved with LED lighting. The fully programmable drivers deliver all dimming options and a range of currents in a single driver. System reliability is maximized with intelligent temperature monitoring of the LED light engine. The full portfolio offers maximum flexibility with customizable operating settings, delivering optimal performance tailored for each design.

Product data

• General Characteristics

Input Frequency	50/60 Hz
IP Classification	-
Lifetime 90% surv.@Tcaselife	80000 hr
Housing Color	Black

• Operating Characteristics

Ripple current	30 %
Efficiency Range	91 %
Output Power Range	20-75 W
Power Factor (100% load)	0.98 (min) -
Input Power max	85 W
Output Voltage Range	54-107 V
Output Current Range (mA)	100-700
Total Harmonic Distortion IEC	10 (max) %
Dimming range Constant Lumen Output	100-10 %
Input Current max	700 (max) mA
Inrush Current Peak	70 (max) A
Output Current Tolerance	-5 (min), 5 (max) %
Inrush Current Width to 50%	120 us
Type of Dimming	1-10V
Input Voltage Range (AC)	120-277 V
Power Factor (dimmed 50%)	0.96 (min) -
Earth leakage current	0.35 (max) mA

Max drivers on MCB(16A type-B)	16 (max) x
Surge Protection (comm./diff.)	4/4 kV
LumiStep Dimming Time	-
LumiStep Time After Midpoint	-

• Wiring Characteristics

Connection on driver to L2	Wire
Input Wire Length	270 mm
Input Wire Diameter	0.82 mm2
Control Wire Diameter	0.82 mm2
Control Wire Length	270 mm
Output Wire Length	270 mm
Output Wire Diameter	0.82 mm2

• Temperature Characteristics

T-case Lifetime	72 C
T-case maximum	80 (max) C
T-ambient	-40 (min), 55 (max) C
Tc Thermal Cut off Driver	85 C
Tc Thermal Cut off Module	Programmable

• Product Dimensions

Length A1	167.5 mm
Length A3	138.1 mm
Width B1	59.1 mm

PHILIPS

Titanium Constant Current Xtreme

Height C1	37.7 mm
Fixing Hole Diameter D1	8.0 mm
Fixing Hole Distance Width B2	42.9 mm
Fixing Hole Distance Length A2	151.6 mm
Length Cable X1	500 mm

Full product code	929000708003
Full product name	Xitanium 75W 0.7A AOCCM 1-10V GL-Y sXt
Order product name	Xitanium 75W 0.7A AOCCM 1-10V GL-Y sXt
Pieces per pack	1
Packing configuration	12
Packs per outerbox	12
Bar code on pack - EAN1	8718291220534
Bar code on outerbox - EAN3	8718291220534
Logistic code(s) - 12NC	929000708003
Net weight per piece	0.803 kg

• Approval&Application Chars

Isolation classification	Class II
ENEC certificate	Yes
CE marking	Yes
RoHS compliance	Yes

• Product Data

Order code	929000708003
------------	--------------

Dimensional drawing

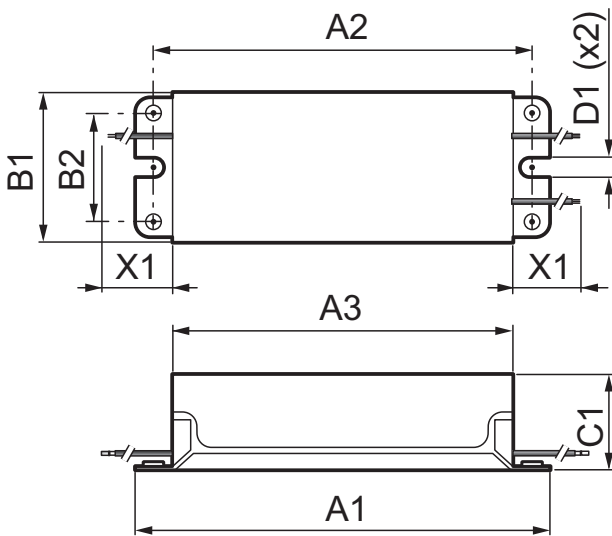

Xitanium 75W 0.7A AOCCM 1-10V GL-Y sXt

Product	A1 (Norm)	A2 (Norm)	A3 (Norm)	B1 (Norm)	B2 (Norm)	C1 (Norm)	D1 (Norm)	X1 (Norm)
Xitanium 75W 0.7A AOCCM 1-10V GL-Y sXt	167.5	151.6	138.1	59.1	42.9	37.7	8.0	500

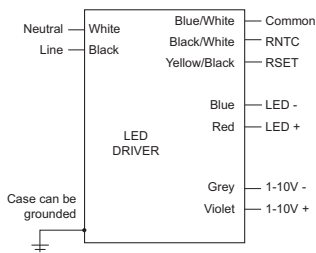

Xitanium 75W 0.7A AOCCM 1-10V GL-Y sXt



© 2013 Koninklijke Philips N.V. (Royal Philips)
All rights reserved.

Specifications are subject to change without notice. Trademarks are the property of Koninklijke Philips N.V. (Royal Philips) or their respective owners.

www.philips.com/lighting

2013, June 25
data subject to change